

TBD EZ Lane
Gravois Mills, MO 65037

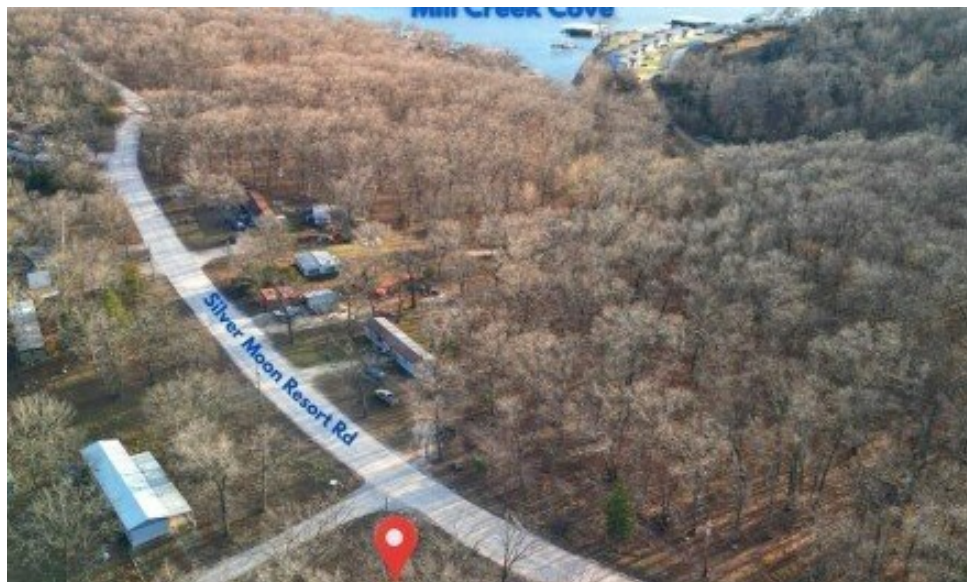

Powered by lakefrontexpo.com

MLS# 3588528



\$22,000

If you've been wishing for extra space near the lake for a shop, man cave, or storage building, this is the opportunity that finally makes sense. Located off P Road in Gravois Mills, this flat, usable land parcel sits just off the lake and offers a rare chance to add functional space close to the water. The land is flat and build friendly, making it a great option for a new build, guest house, or secondary structure to complement nearby lake homes. The location is excellent with close proximity to Mermaid Cove Marina & RV Resort, Lake Burger and Mill Creek Cove, making it especially ideal for nearby homeowners or RV owners who need additional storage. This setting keeps you near the lake while still enjoying easy access by road. The property offers road frontage along Silver Moon Resort Rd & EZ Lane Rd, adding flexibility for access and future use. Practical, versatile and increasingly hard to find, this property delivers the kind of convenience that enhances lake life without the lakefront price tag.



Sheri Rieke

Keller Williams L O Realty/West

For full listing details, please scan:

