

**000 County Road 51**  
Lockwood, MO 65682

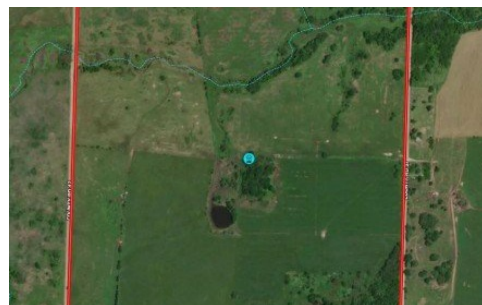

Powered by lakefrontexpo.com

MLS# SOM60316228



**\$800,000**

160 acres in Dade County located directly across from Stony Point Prairie Conservation Area, offering exceptional views and abundant wildlife. With three sides of road frontage, this property provides outstanding access. The farm is fenced and cross-fenced, ready for rotational grazing. Improvements include a well, seven waterers, electric on site, two ponds, and two wet weather branches providing additional water sources. This is a turnkey setup for livestock producers, with strong recreational and hunting potential thanks to its proximity to conservation ground.



**Kelly Roy**

Phone: (417) 298-0071

Missouri Home, Farm & Land Realty, LLC

For full listing details, please scan:

