

20A Sylvan Bay Drive
Linn Creek, MO 65052

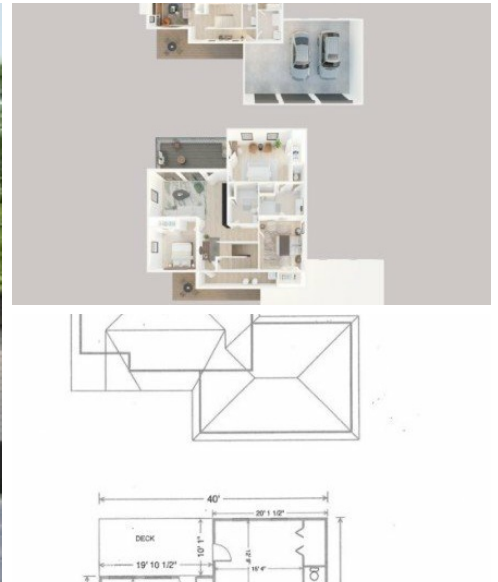

Powered by lakefrontexpo.com

MLS# 3577150



\$695,000

4 Bedrooms | 4 Bathrooms | 2,700 Sqft

CURRENTLY UNDER CONSTRUCTION! This stunning custom-built modern ranch-style home offers 4 bedrooms and 3.5 baths with 2,700 sq ft of thoughtfully designed living space, all set on a spacious lot in the beautiful Lake of the Ozarks. Enjoy lake views and easy access to the water, making it ideal for both relaxation and recreation. The open-concept layout features high ceilings, sleek finishes, and large windows that fill the home with natural light and a gas fireplace adorned with custom stonework. A gourmet kitchen, luxurious primary suite, and covered outdoor space create the perfect blend of comfort and style. Whether you're entertaining or unwinding, this lake-view retreat offers the best of modern lake living. Community dock with 12 x 32 boat slip available for purchase.



LYNN FARRELL

John Farrell Real Estate Co.

For full listing details, please scan:

