

Emerald Hills Drive
Edwards, MO 65326

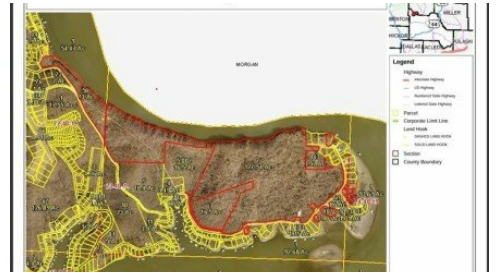

Powered by lakefrontexpo.com

MLS# 3572079



\$1,399,999

Don't miss out on this rare opportunity to acquire a vast tract of land in a prime lakeside location. Large tracts and numerous lots make up these 14 Parcels of wooded landscape with multiple terrains, within the gated Emerald Hills. The 160+ acres boast more than 6300 feet of Lake of the Ozarks shoreline. Electric, waste treatment and water well already in place, capable of servicing up to 75 homes, 10+ lots have utilities at the properties. The 100x50 Barn with electric, water, and sewer already installed perfect for storage, office space, or on-site operations. Sellers are also offering the following equipment: John Deere backhoe, John Deere 240 skidsteer, Kabota LA805 L4060 tractor with loader and brush hog and a second tractor, everything you need to get started on development right away! Come take a look and let your imagination run wild with the endless possibilities this property offers!



Joanna Boulware

Better Homes and Gardens Real Estate Lake Realty

For full listing details, please scan:

